

INSTALLATION INSTRUCTIONS

Home Slicker® Plus Typar® and Home Slicker® 10 Plus Typar®

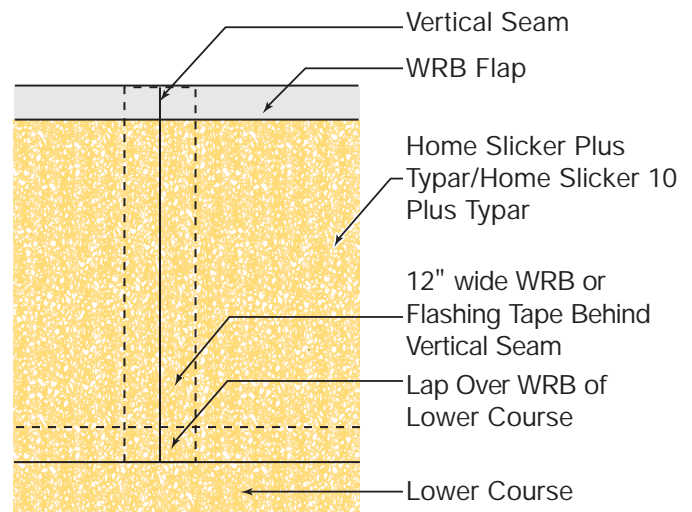
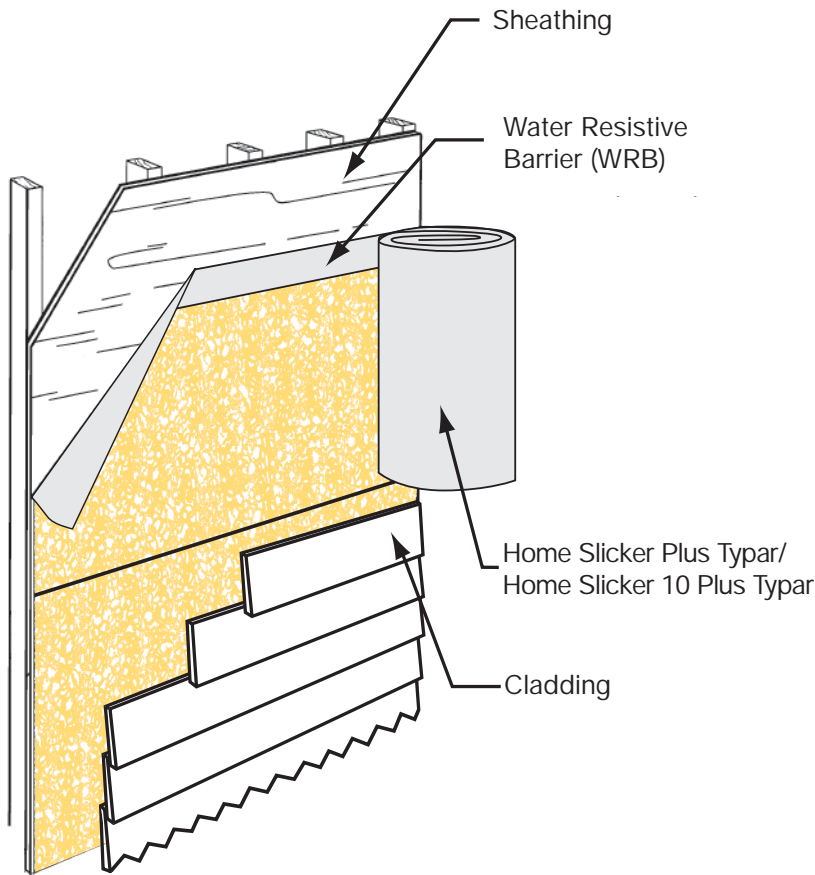

1. Install sidewall sheathing material over studs. Install Home Slicker Plus Typar/Home Slicker 10 Plus Typar after windows and doors are properly installed and flashed. Refer to window installation for details on flashing integration.
2. Roll out Home Slicker Plus Typar/Home Slicker 10 Plus Typar wherever siding or cladding will be applied with channels running vertically and the extra water resistant barrier (WRB) flap on top. (For stucco or stone applications, install an additional WRB over the exposed channels of Home Slicker Plus Typar/Home Slicker 10 Plus Typar. Home Slicker Plus Typar/Home Slicker 10 Plus Typar must roll out left to right. Nail or staple (min. 1/2" staple) every 3 square feet.
3. To create a vertical seam between rolls, install a 12"-wide WRB, such as Typar, behind vertical joint. The bottom of the flashing should be lapped over the WRB flap of the lower course. Optionally, attach flashing tape to the back of the WRB at the end of each roll. Center the flashing so half extends past the roll's end with the sticky side out. Butt the next roll and seal onto other half of flashing. Proceed up the wall. The higher course should overlap the WRB on the lower course. Butt edges of Home Slicker matrix together with the WRB lapped underneath the new roll.
4. Install siding or cladding system over wall surface within 30 days of Home Slicker application per manufacturer's installation instructions. Allow for thickness of Home Slicker Plus Typar/Home Slicker 10 plus Typar in nail selection. *Do not overnail.